

# 2009 RREV Remount

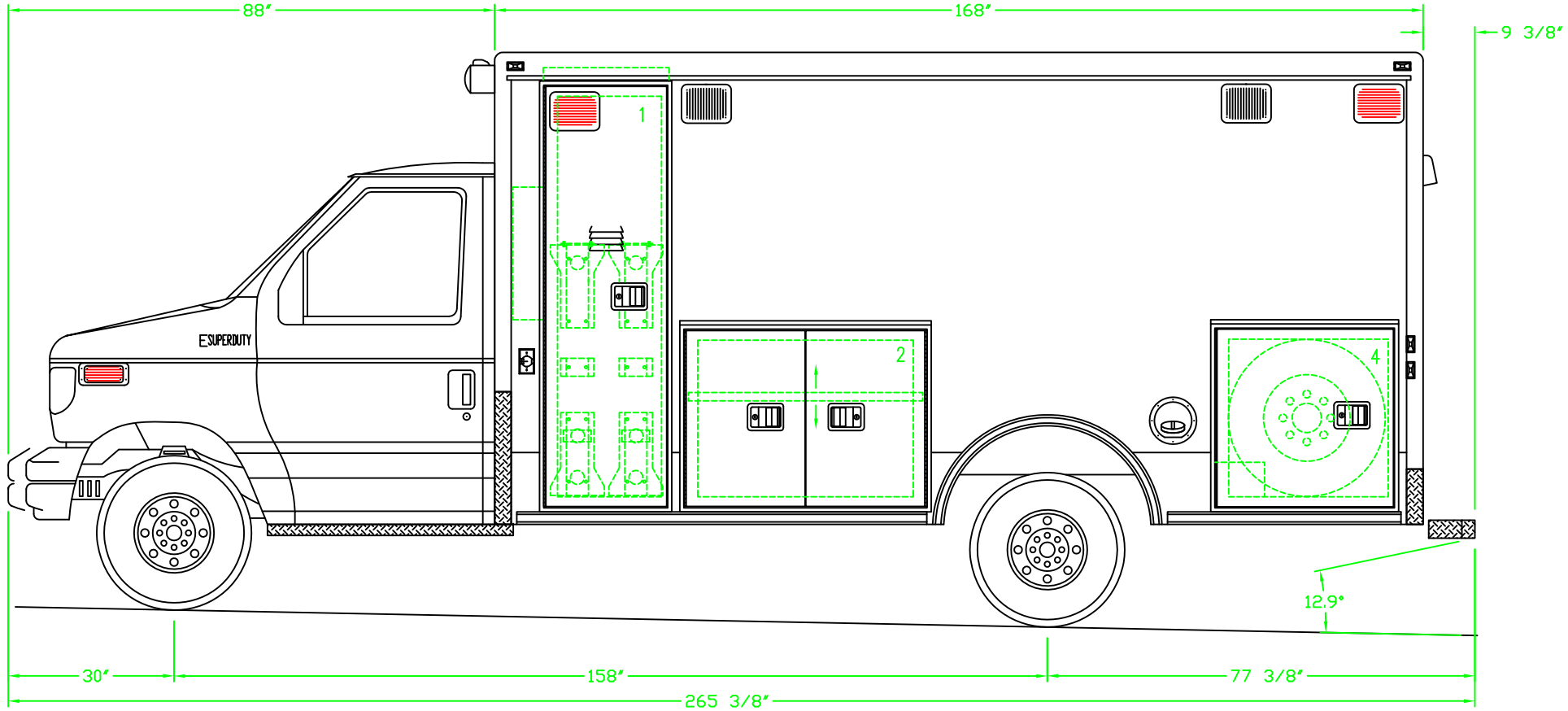

DOOR NO.	INTERIOR DIMENSIONS			OPENING DIMENSIONS		MISC. NOTES	NOTES:
	HEIGHT	WIDTH	DEPTH	HEIGHT	WIDTH		
1	77.25"	23.25"	20.75"	72.25"	19.00"	DOOR LOUVERS	
2	30.50"	44.12"	18.75"	28.50"	39.00"	(1) ADJ. SHELF	
4	30.50"	32.75"	18.75"	28.50"	29.12"	SPARE TIRE STORAGE	

STREETSIDE EXTERIOR DETAIL					BID NUMBER	
	DATE 05/05/09	REVISION 1	REVISION 2	REVISION 3	SCALE NONE	SHEET 1 OF 9

# 2009 RREV Remount

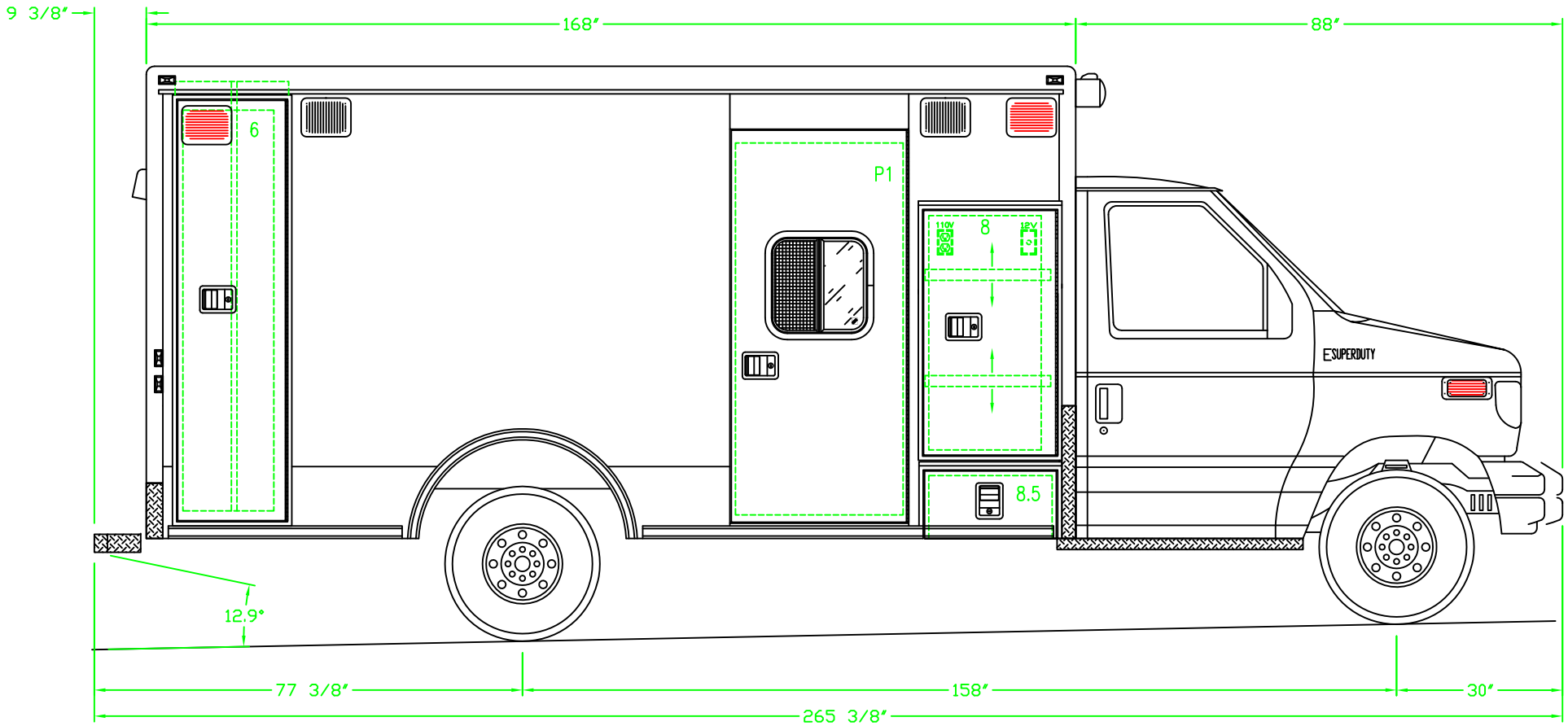

DOOR NO.	INTERIOR DIMENSIONS			OPENING DIMENSIONS		MISC. NOTES	DOOR NO.	INTERIOR DIMENSIONS			OPENING DIMENSIONS		MISC. NOTES
	HEIGHT	WIDTH	DEPTH	HEIGHT	WIDTH			HEIGHT	WIDTH	DEPTH	HEIGHT	WIDTH	
6	77.25"	22.00"	18.75"	70.25"	16.75"	(1) ADJ. DIVIDER	P1	N/A	N/A	N/A	67.25"	30.25"	18"x18" SLIDING TINTED WINDOW
8	45.25"	22.75"	29.00"	42.25"	20.25"	(2) ADJ. SHELVES	NOTES:						
8.5	12.00"	24.25"	20.75"	11.00"	22.25"	BATTERY DRAWER FOR (3) BATTERIES							

## CURBSIDE EXTERIOR DETAIL

BID NUMBER

DATE  
05/05/09

REVISION 1

REVISION 2

REVISION 3

SCALE  
NONE

SHEET 2 OF 9



# 2009 RREV Remount

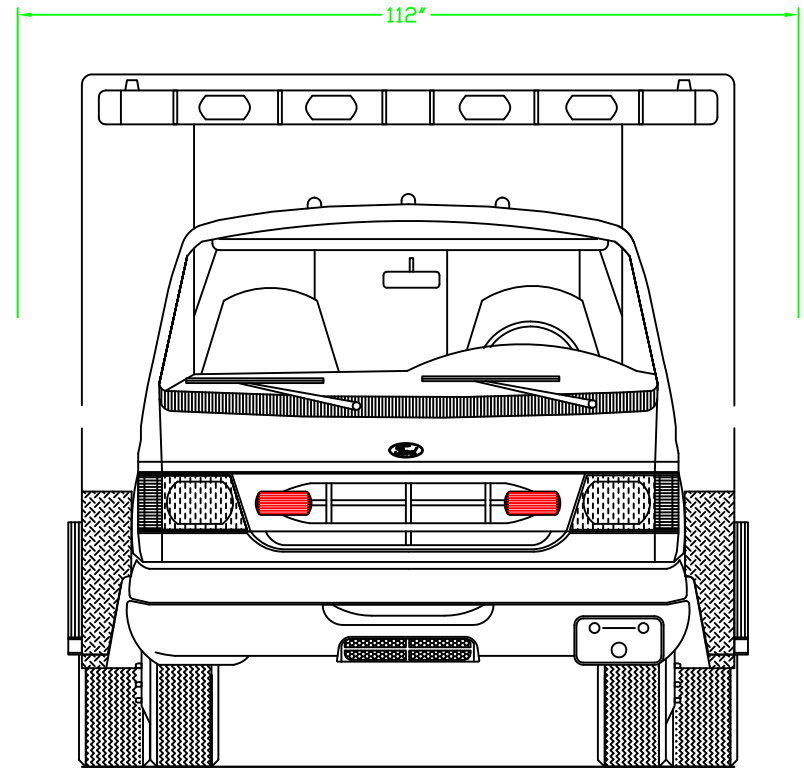
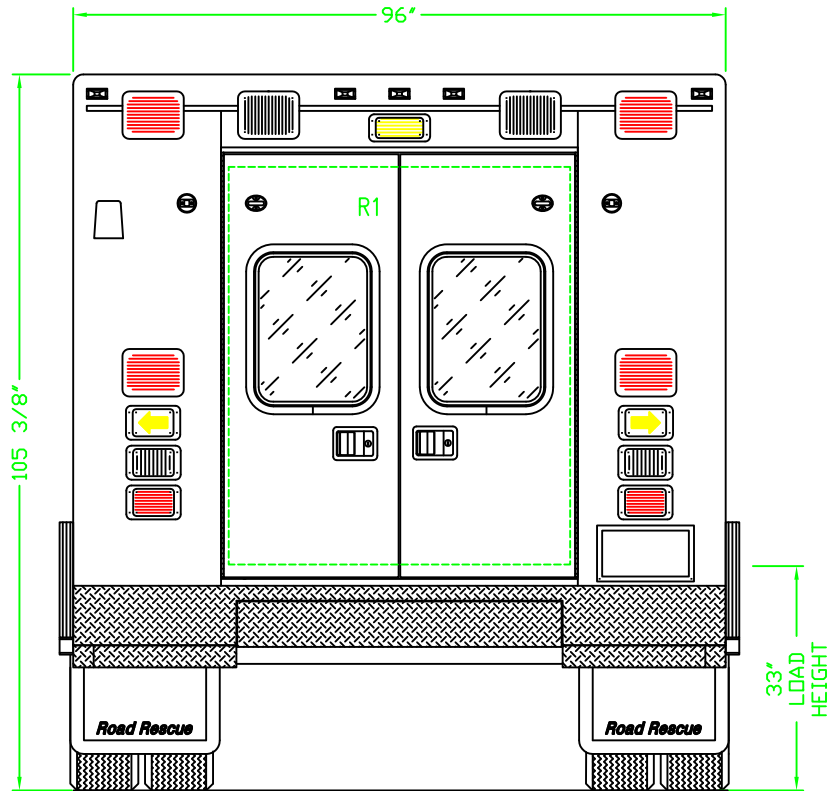



DOOR NO.	INTERIOR DIMENSIONS			OPENING DIMENSIONS		MISC. NOTES
	HEIGHT	WIDTH	DEPTH	HEIGHT	WIDTH	
R1	N/A	N/A	N/A	58.50"	50.25"	23"x18" FIXED TINTED WINDOWS
NOTES:						

NOTES: REAR BUMPER TO HAVE A FLIP-UP CENTER SECTION WITH 9" REINFORCED GRIP STRUT.

## FRONT & REAR EXTERIOR DETAIL

BID NUMBER

DATE: 05/05/09    REVISION 1    REVISION 2    REVISION 3    SCALE: NONE    SHEET 3 OF 9

# 2009 RREV Remount

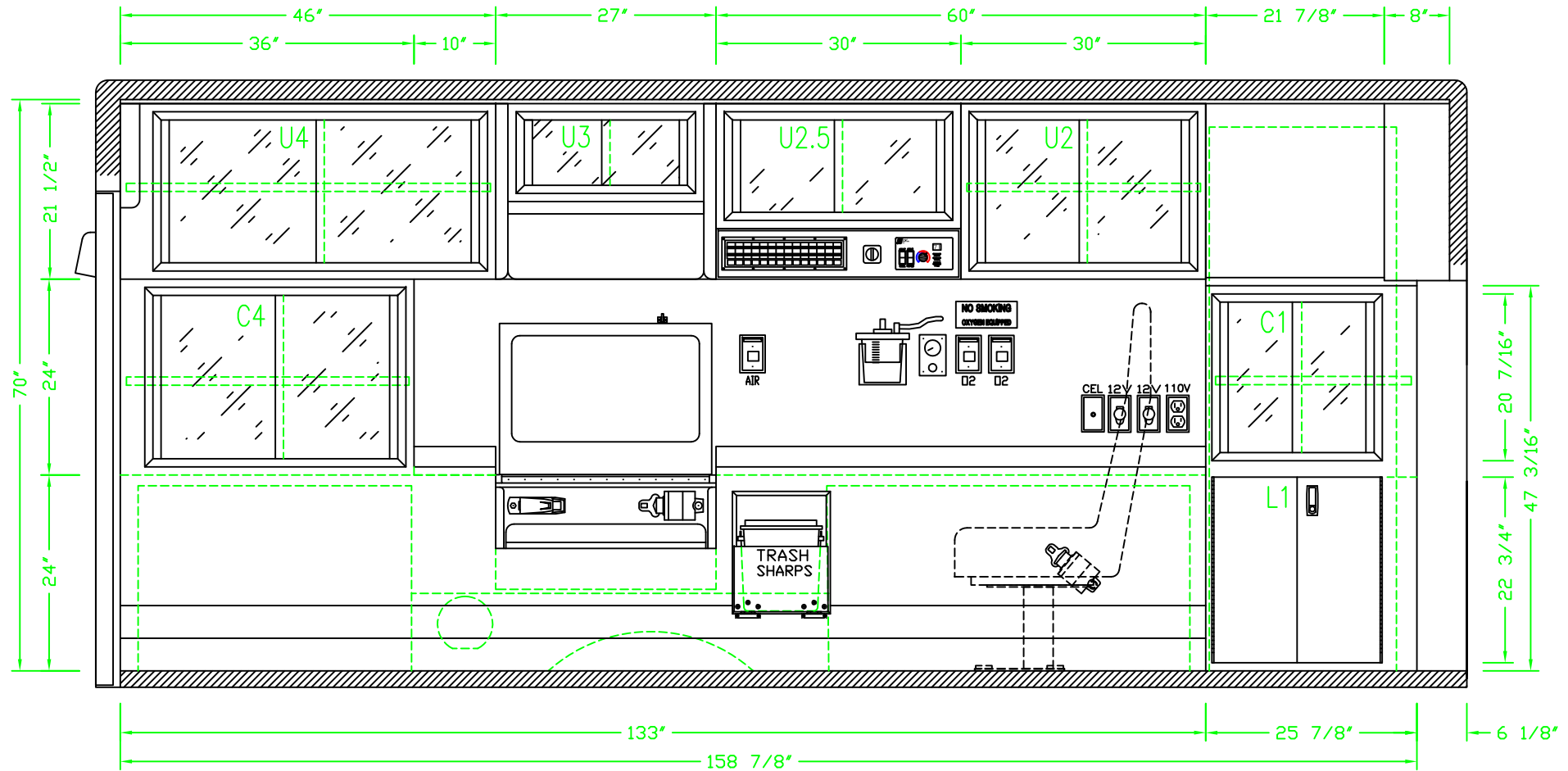

DOOR NO.	INTERIOR DIMENSIONS			OPENING DIMENSIONS		MISC. NOTES	DOOR NO.	INTERIOR DIMENSIONS			OPENING DIMENSIONS		MISC. NOTES
	HEIGHT	WIDTH	DEPTH	HEIGHT	WIDTH			HEIGHT	WIDTH	DEPTH	HEIGHT	WIDTH	
L1	23.75"	25.87"	15.50"	22.75"	20.87"	DBL SOLID ALUM, NON-LKG	U4	21.50"	46.00"	13.00"	19.50"	41.00"	RESTOCK, (1) ADJ. SHELF
C1	23.00"	25.87"	15.50"	20.43"	20.87"	SLIDING PLEX, (1) ADJ. SHELF	C4	24.00"	36.00"	19.25"	22.00"	32.00"	SLIDING PLEX, (1) ADJ. SHELF
U2	21.50"	30.00"	15.00"	19.50"	28.00"	RESTOCK, (1) ADJ. SHELF	NOTES:						
U2.5	15.31"	30.00"	15.00"	13.31"	28.00"	RESTOCK, (1) ADJ. SHELF							

## STREETSIDE INTERIOR DETAIL

BID NUMBER

DATE 10/28/99  
REVISION 1 11/29/99

REVISION 2

REVISION 3

SCALE NONE

SHEET 4 OF 9



# 2009 RREV Remount

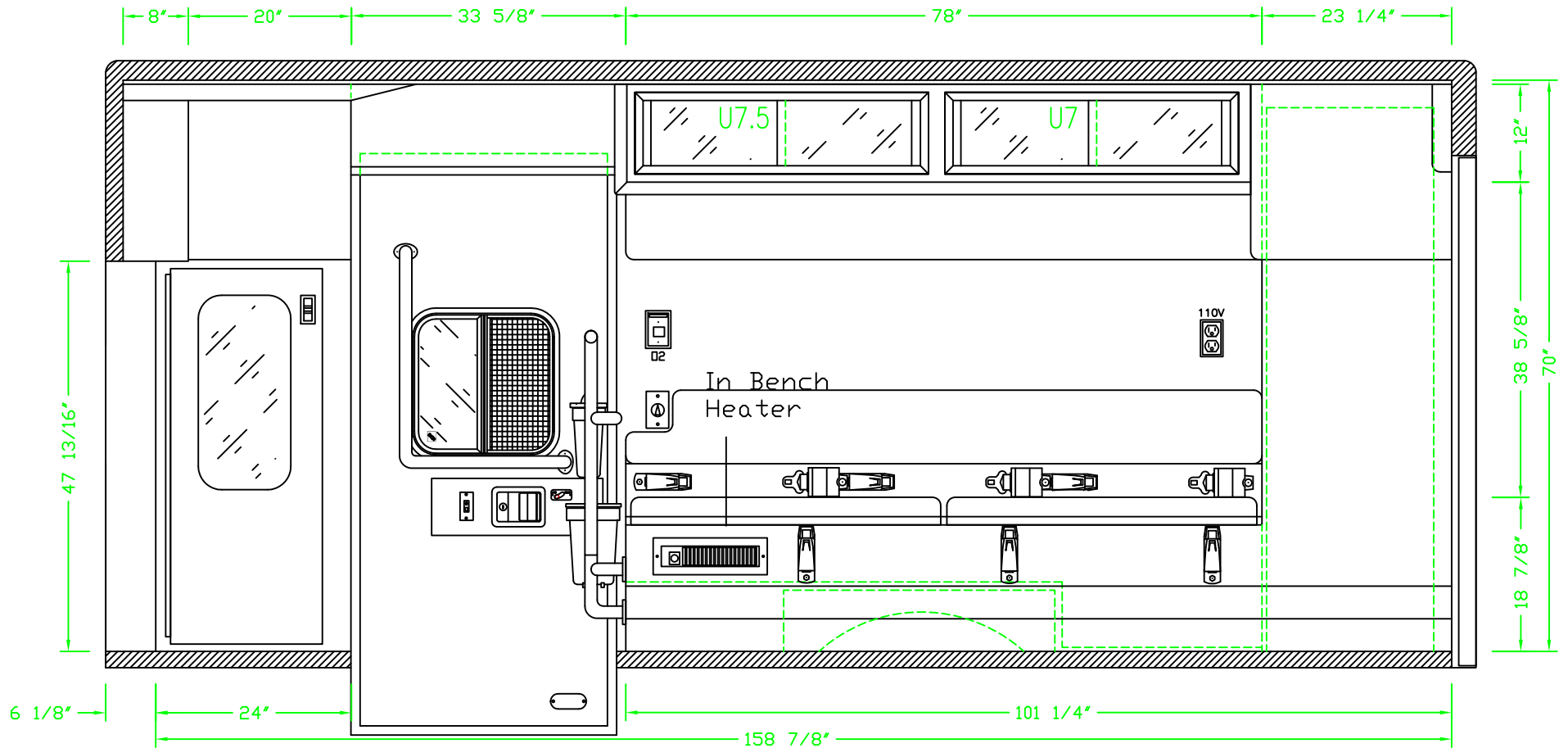

DOOR NO.	INTERIOR DIMENSIONS			OPENING DIMENSIONS		MISC. NOTES	NOTES:
	HEIGHT	WIDTH	DEPTH	HEIGHT	WIDTH		
U7	12.00"	40.00"	10.75"	10.00"	36.00"	RESTOCK	
U7.5	12.00"	38.00"	10.75"	10.00"	36.00"	RESTOCK	
NOTES:							

## CURBSIDE INTERIOR DETAIL

BID NUMBER

DATE  
10/28/99

REVISION 1  
11/29/99

REVISION 2

REVISION 3

SCALE  
NONE

SHEET 5 OF 9



# 2009 RREV Remount

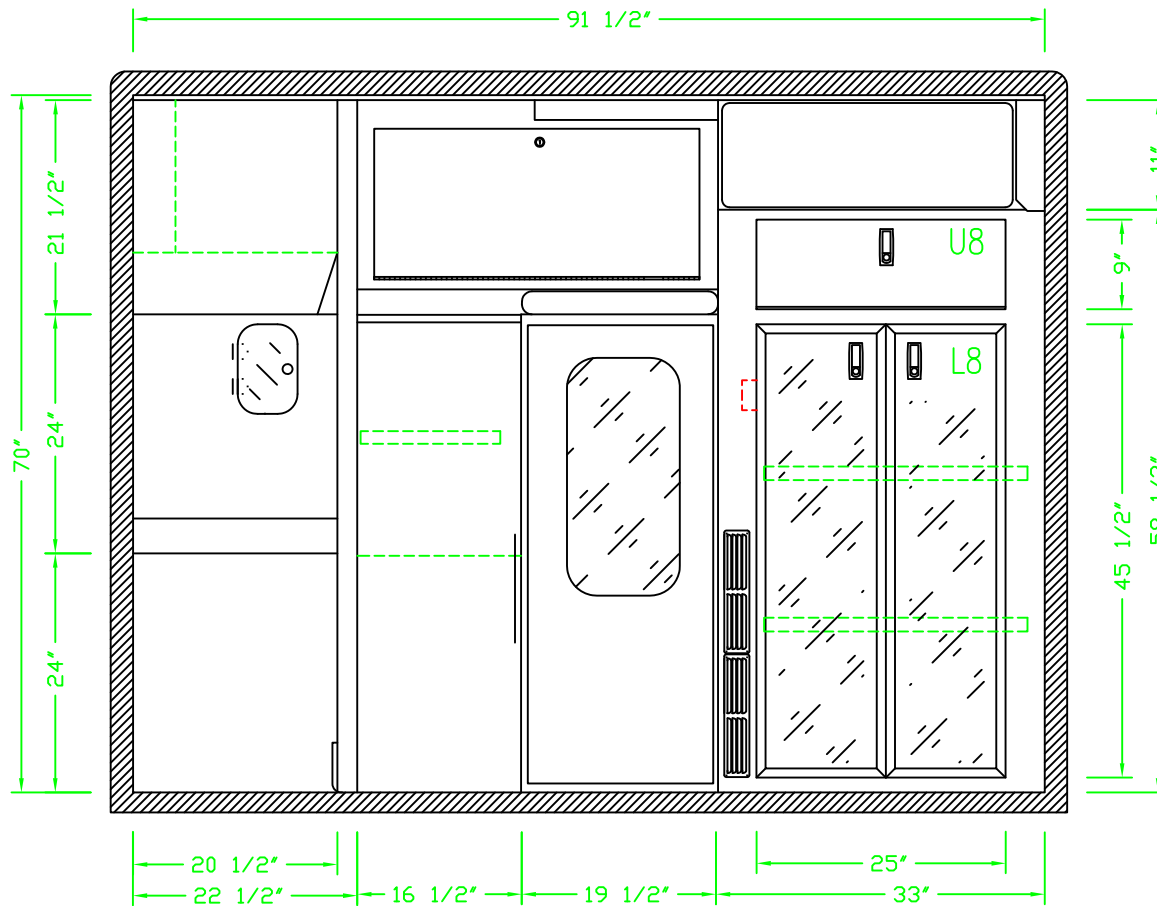

DOOR NO.	INTERIOR DIMENSIONS			OPENING DIMENSIONS		MISC. NOTES
	HEIGHT	WIDTH	DEPTH	HEIGHT	WIDTH	
U8	10.00"	25.00"	22.75"	9.00"	25.00"	SGL SOLID ALUM, LKG LATCH
L8	48.50"	29.00"	22.75"	45.50"	25.00"	DBL LEXAN, NON-LKG, (2) ADJ. SHELVES

NOTES:

## FRONT INTERIOR DETAIL

BID NUMBER

DATE  
10/28/99

REVISION 1  
11/29/99

REVISION 2

REVISION 3

SCALE  
NONE

SHEET 6 OF 9



# 2009 RREV Remount

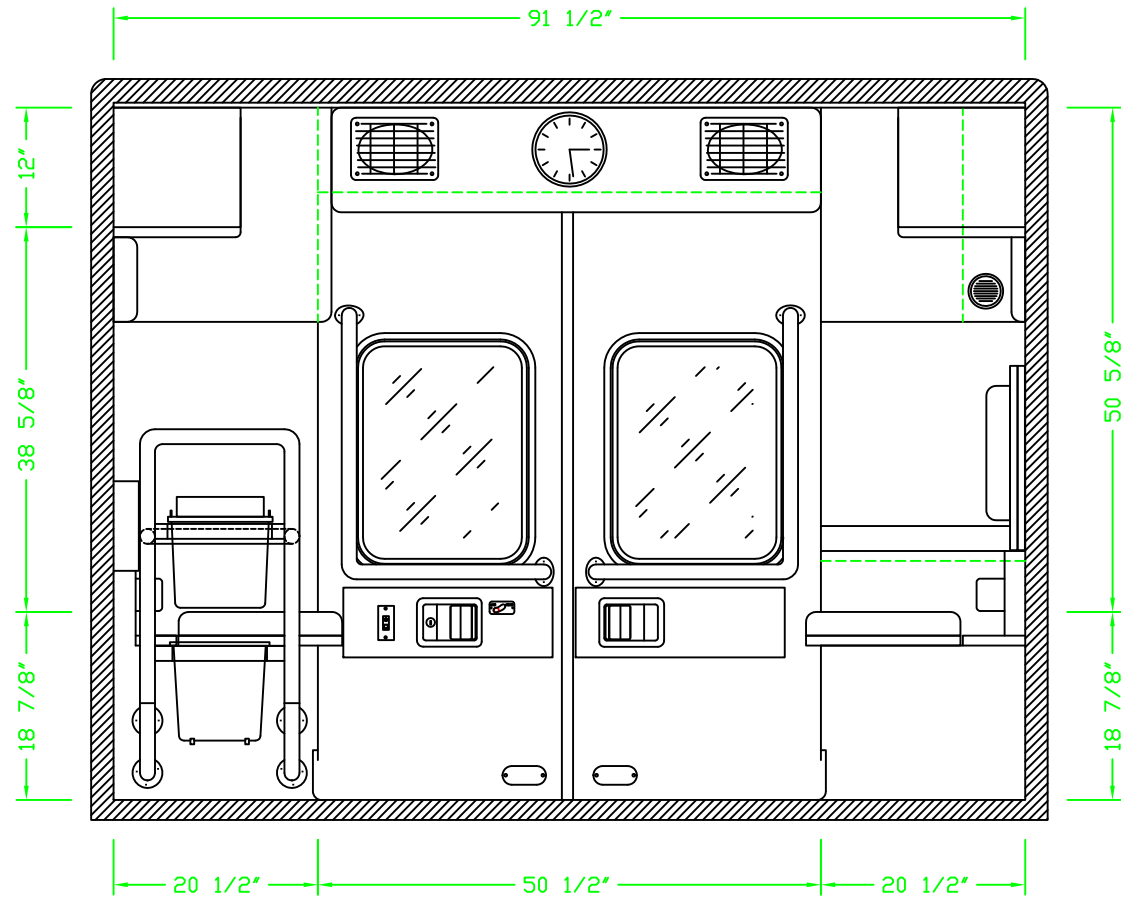

NOTES:

NOTES:

## REAR INTERIOR DETAIL

BID NUMBER

DATE  
10/28/99

REVISION 1  
11/29/99

REVISION 2

REVISION 3

SCALE  
NONE

SHEET 7 OF 9



# 2009 RREV Remount

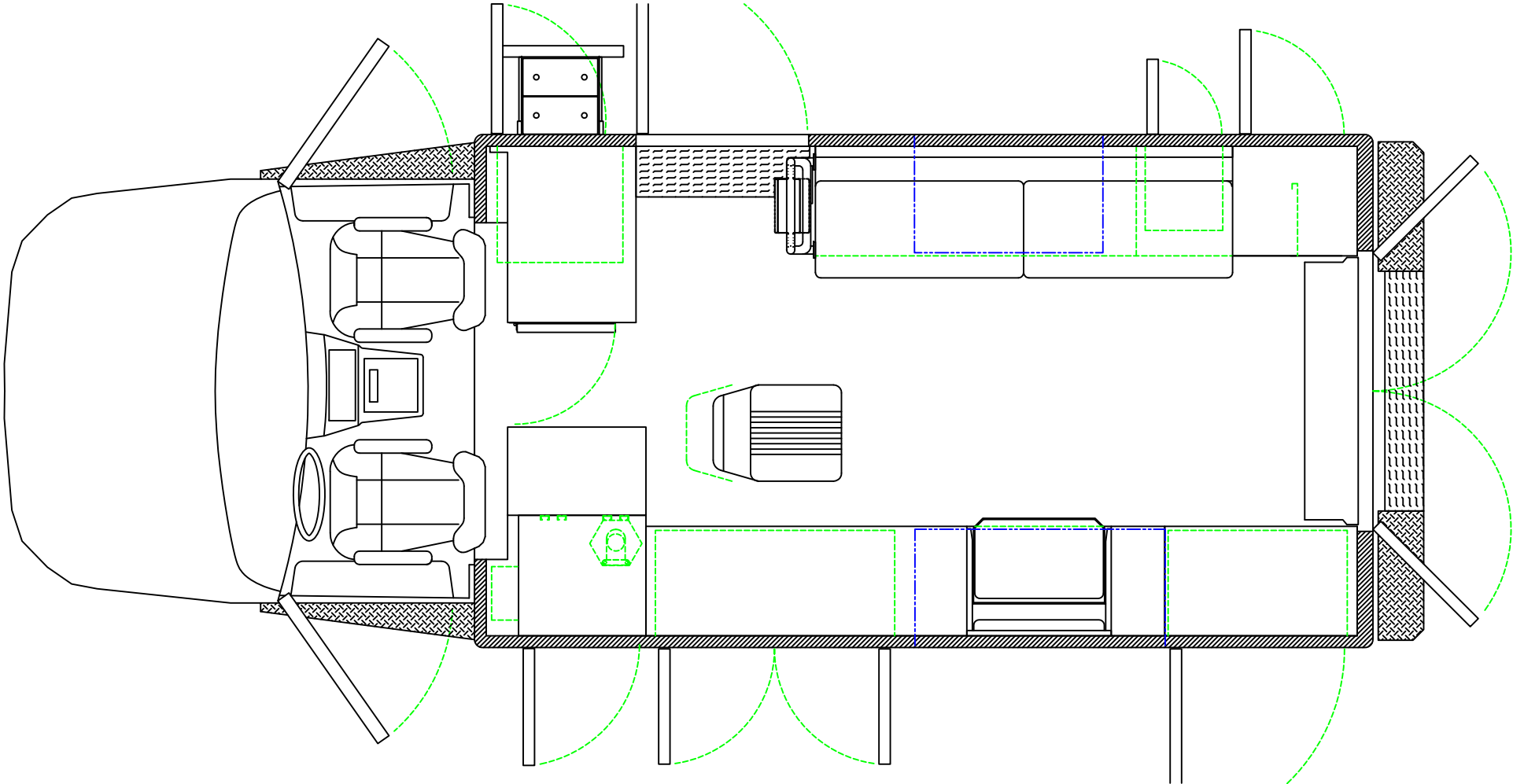

NOTES:

NOTES:

## OVERHEAD FLOOR DETAIL

DATE 05/05/09	REVISION 1	REVISION 2	REVISION 3
------------------	------------	------------	------------

SCALE NONE	SHEET 8 OF 9
---------------	--------------

BID NUMBER <div style="display: flex; justify-content: space-between; align-items: center;"> </div>
--

# 2009 RREV Remount

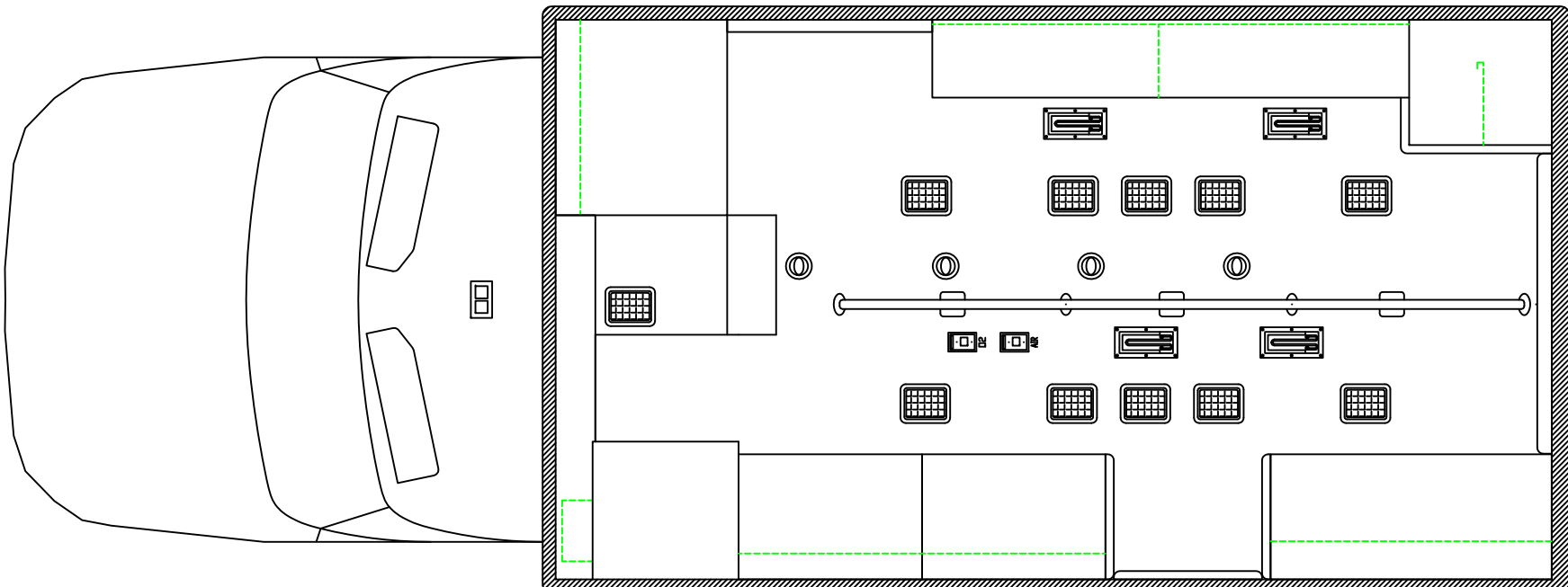

NOTES:

NOTES:

## OVERHEAD CEILING DETAIL

DATE  
05/05/09

REVISION 1

REVISION 2

REVISION 3

SCALE  
NONE

SHEET 9 OF 9

BID NUMBER

